

"Stay Connected" with



Liquid Tight Conduit, Tubing & Fittings

a PennEngineering® Company



## Heyco-Flex™ Mounting Brackets

- For mounting Heyco-Flex Conduit or Tubing securely into place, vertically or horizontally. See pages 2-1, 2-7, and 2-8.
- Only fingertip pressure is required to snap conduit or tubing into bracket.
- Low profile design for space savings and pleasing appearance.
- Recommended distance between brackets at intervals not greater than 3 feet (1m) as required by Article 351-27 of 1996 NEC.
- Use one standard #10 (4-5M) screw for attaching bracket to panel (screw not included).
- Resist salt water, weak acids, gasoline, alcohol, oil, grease, and common solvents.

FITS CONDUIT/ TUBING SIZE	PART NO.		DESCRIPTION	PART DIMENSIONS									
	Black	Gray		A		B		C		D		E	
				Inside Dia.	mm.	Length	mm.	Height	mm.	Outside Dia.	mm.	Width	mm.
3/8	1025	1026	HFB 3/8	.66	16,9	.91	23,2	.72	18,2	.90	22,9	.75	19,1
1/2	1027	1028	HFB 1/2	.79	20,0	1.07	27,3	.71	18,0	1.06	26,8		
3/4	1029	1030	HFB 3/4	1.05	26,7	1.27	32,2	.67	17,0	1.31	33,2		
1	1031	1032	HFB 1	1.24	31,5	1.52	38,6	.84	21,3	1.53	38,9		

Standard color black or gray.

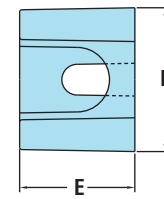
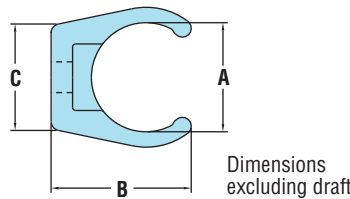

Dimensions excluding draft



## Heyco® Sealing Washers

- For use with Heyco-Flex fittings.
- Liquid tight, dust tight, and oil tight at enclosure.
- Suitable for wet locations requiring a separate gasket between the box and fitting.
- Also suitable for other panel sealing applications.
- Easy to install since washers seal off on the perimeter, not on the connector threads.
- Special double sealing ridges compensate for minor unevenness at enclosure.

Will Fit These Electrical Fitting NPT Trade Sizes	PART NO.	DESCRIPTION	PART DIMENSIONS					
			A Inside Diameter		B Outside Diameter		C Thickness	
			in.	mm.	in.	mm.	in.	mm.
1/4	3258	SW 1/4	.54	13,7	.80	20,2	.13	3,2
3/8	3259	SW 3/8	.67	17,0	1.01	25,5		
1/2	3260	SW 1/2	.85	21,6	1.24	31,5		
3/4	3261	SW 3/4	1.03	26,2	1.50	38,1	.14	3,4
1	3262	SW 1	1.28	32,5	1.77	45,0		
1-1/4	3264	SW 1-1/4	1.66	42,2	2.16	54,8	.16	4,1
1-1/2	3265	SW 1-1/2	1.86	47,2	2.44	62,0		
2	3257	SW 2	2.32	58,9	2.93	74,4	.18	4,6

Standard color black.

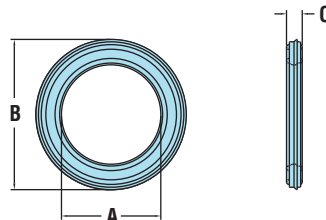

Quick  
Specs

Material	HFB - Nylon 6/6	SW - Thermoplastic Elastomer
Flammability Rating	HFB - 94V-2	SW - 94V-0
Temperature Range	-22°F (-30°C) to 221°F (105°C)	