



**3043**

## Heyco® Zinc Die-Cast Box Connectors

TRADE SIZE	NOMINAL MOUNTING HOLE DIAMETER		WILL FIT THESE CABLES* Flexible Metallic Conduit	Non-Metallic Sheathed		PART NO.	DESCRIPTION	PART DIMENSIONS					
	in.	mm.		Armored ***				A		B			
								Minimum Wire	Maximum Wire	Overall Length			
								in.	mm.	in.	mm.		
<b>Clamp-Type Connector</b>													
3/8**	.875	22,2	-	14/2, 14/3, 12/2, 12/3, 10/2, 10/3	14/2, 12/2, 12/3	<b>3043</b>	751 aka Romex® Connector	.18	4,6	.64	16,3	.81 20,6	
<b>90° Angle Connectors</b>													
3/8**	.875	22,2	3/8	14/2, 14/3, 14/4, 12/2, 12/3, 12/4, 10/2, 8/1, 6/1, 4/1	-	<b>3030</b>	561	.45	11,4	.63	16,0	1.81 46,0	
1/2	.875	22,2	1/2	8/2	-	<b>3031</b>	563	.65	16,5	.97	24,6	2.05 52,1	
<b>Combination Connectors</b>													
3/8**	.875	22,2	3/8	14/2, 14/3, 14/4, 12/2, 12/3, 12/4	14/2, 14/3, 12/2, 12/3	<b>3029</b>	551	.35	9,0	.43	11,0	.79 20,0	
						<b>3040</b>	551 No Nut						
<b>Box Connector</b>													
1/2	.875	22,2	n/a	n/a	n/a	<b>9840</b>	SP1	.40	10,2	1.12	28,4	.31 7,9	

\*Gauge/Conductors, except FMC.  
 \*\*1/2" K.O.  
 \*\*\*Not UL Rated for armored cable.

**Part No. 3043** (751) commonly known as a Romex® Connector.

- Also fits corrugated MC at .51" (13,0 mm) diameter, smooth MC at .35" (8,8 mm) to .53" (13,3 mm) diameter.
- DFARS Compliant
- For Heyco Liquid Tight Romex Connectors, see page 3-16.



**9840**

- Provides a connecting link between boxes, panels or chassis.
- Space boxes 5/16" (7,9 mm) apart.
- Die-cast locknut included.
- DFARS Compliant

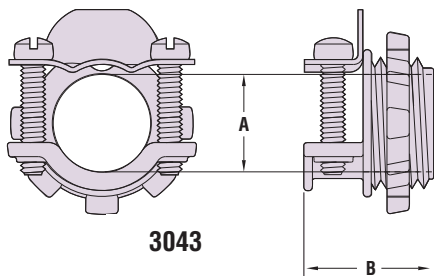

**3043**

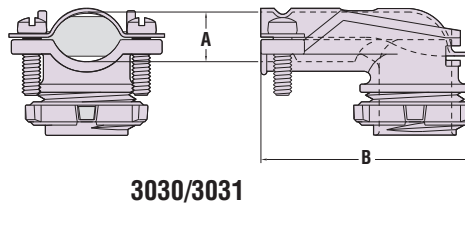

**3030/3031**

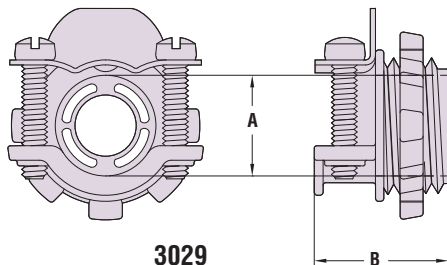

**3029**

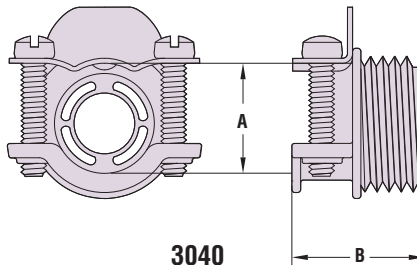

**3040**

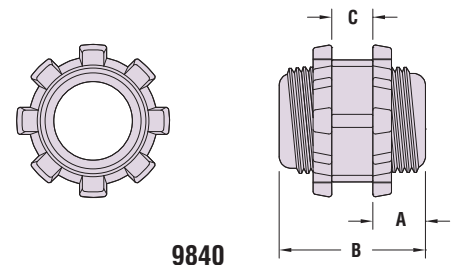

**9840**

Material: Zamak 3  
 Certifications: Listed under Underwriters' Laboratories File E103541  
 Certified by the Canadian Standards Association File 88539

*Quick Specs*